



**TO:** Reviewing Agencies  
Other Interested Parties

**FROM:** Leah Allison, AICP, Senior Urban Planner *LA*  
Planning and Growth Management Department

**DATE:** November 30, 2007

**SUBJECT: Prospect and Sheridan Enterprise Zone Expansions – CPC 07-JJ**

Please see the attached Prospect and Sheridan Enterprise Zone Expansion Maps. This is a request of the CITY OF PEORIA for APPROVAL OF ENTERPRISE ZONE EXPANSIONS to add the Prospect Form District, which is the area generally bounded by War Memorial Drive on the north and Forrest Hill Avenue on the south; and the Sheridan Form District, which is the area generally bounded by McClure Avenue on the south and Hanssler Place on the north.

Please submit any comments or concerns relating to this case to the Planning and Growth Management Department no later than **Friday, December 7, 2007.**

Should you need more information, feel free to contact me at 494-8667.

LA/ps

Attachments (4)

Cc: Council Member Van Auken  
Council Member Manning

PAS/P/PLANNINGCOMMISSION/CPC07-JJ/REVIEWINGAGENCIES



*Twin Towers Building  
456 Fulton Street, Suite 402  
Peoria, Illinois 61602  
309/494-8600  
FAX 309/494-8680*

### 6.3 PROSPECT ROAD

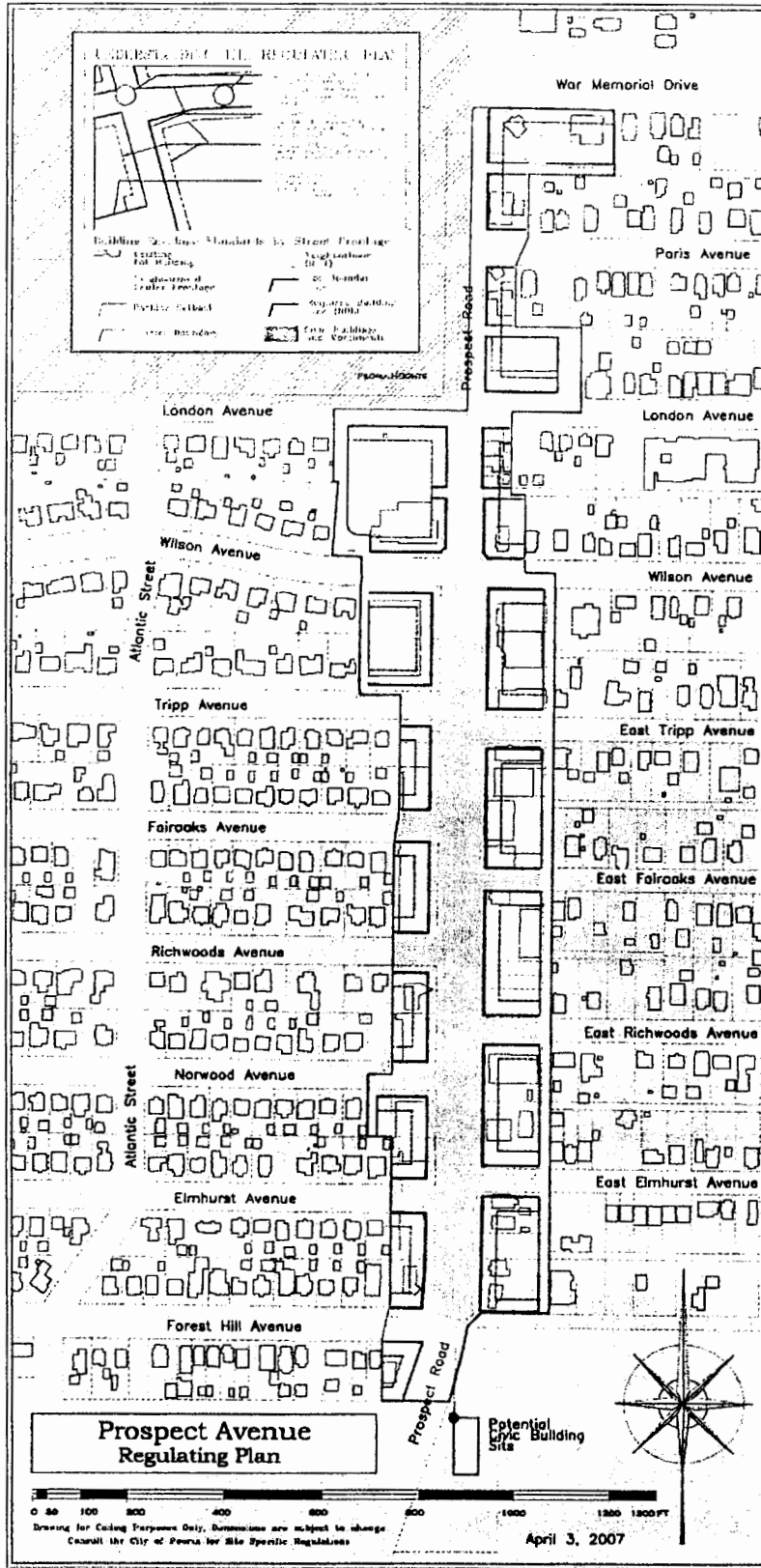

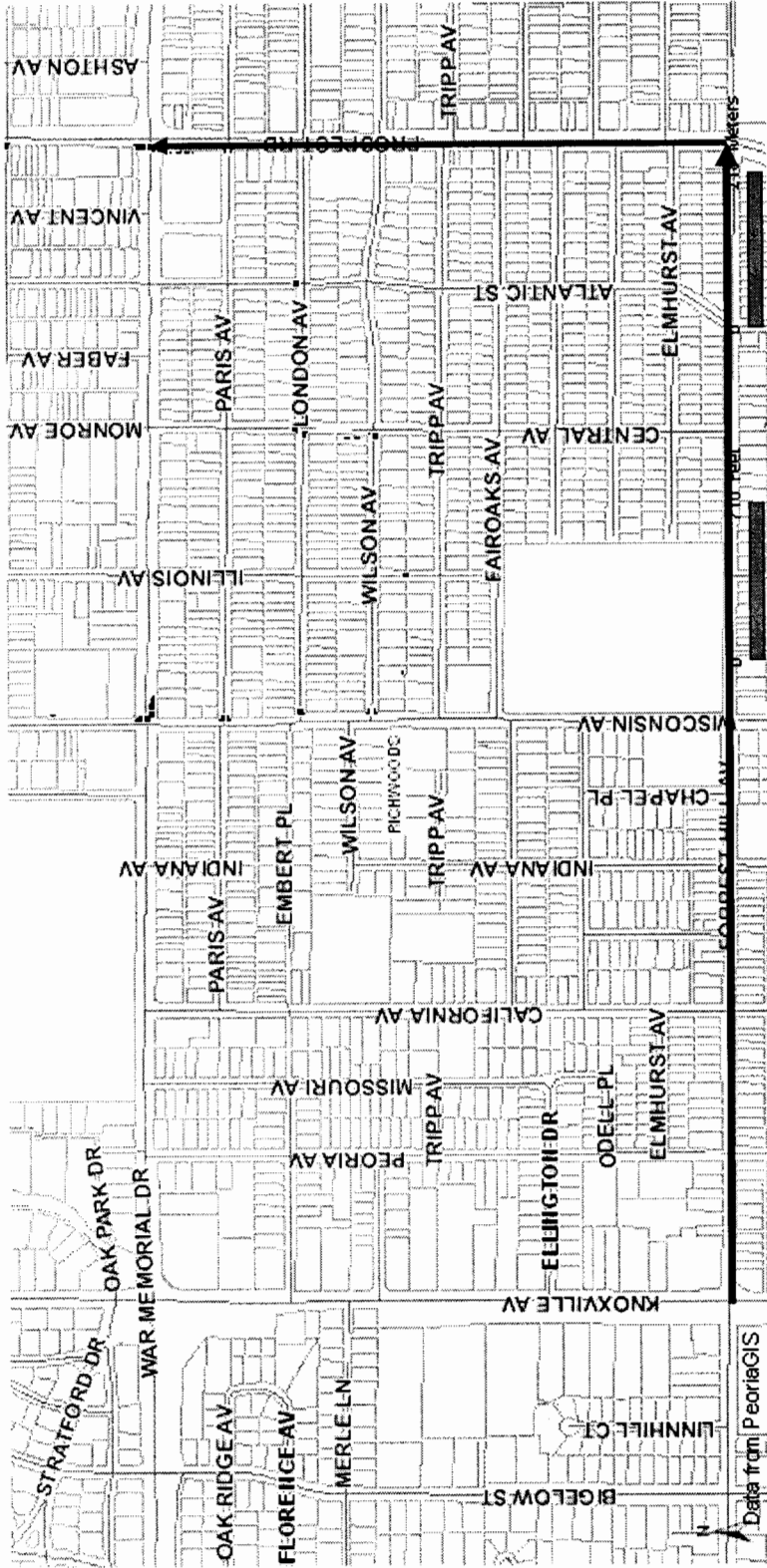

**PROSPECT ROAD**  
 Connector will be from Knoxville to  
 Forrest Hill to Prospect Rd.

6.2 SHERIDAN TRIANGLE

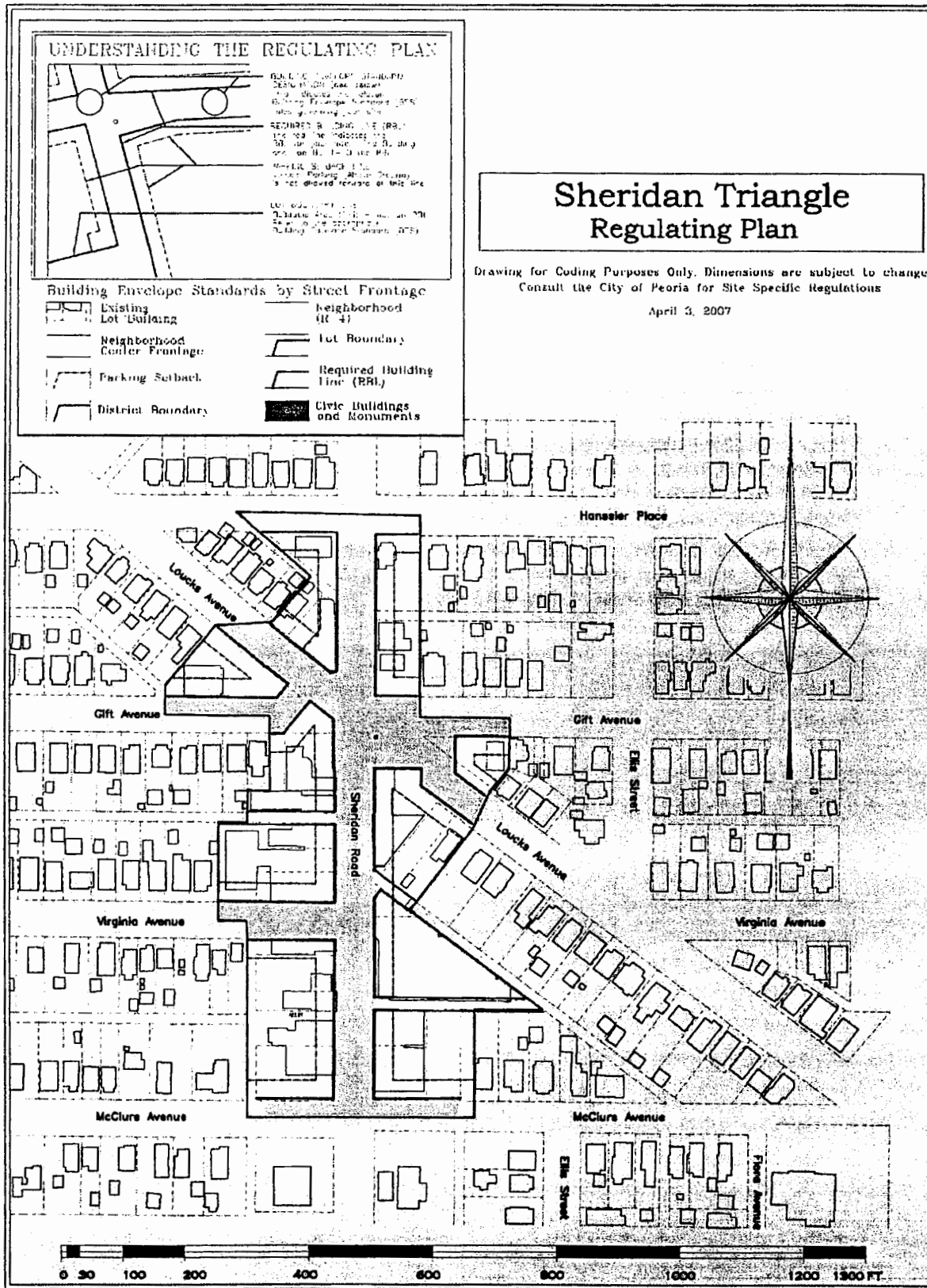



**SHERIDAN RD.**  
 Connector will run from Knoxville to  
 to McClure to Sheridan